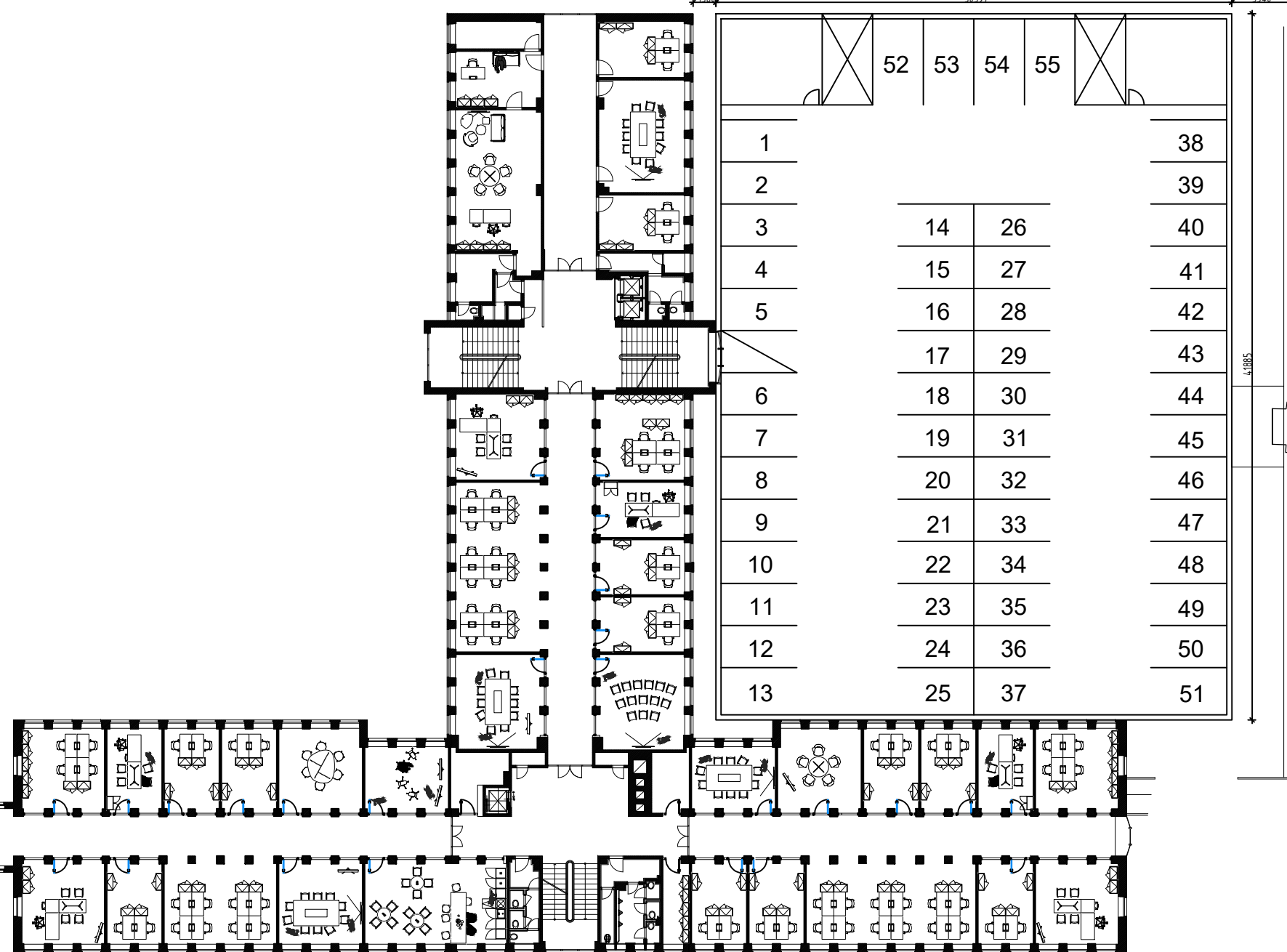

This detailed floor plan shows a building with two long wings connected by a central staircase and a small central area. The left wing contains a variety of rooms, including a large conference room with a long table and many chairs, several smaller meeting rooms with round and rectangular tables, and a reception area with a desk and chairs. The right wing is more uniform, featuring a series of rectangular meeting rooms, each equipped with a table and chairs. A central staircase is located between the two wings, and a small central area with a desk and chairs is also present. The plan includes numerous doors, windows, and furniture items like tables, chairs, and desks, providing a comprehensive view of the building's layout.

[illegible]